

AMENDMENT OF SOLICITATION / MODIFICATION OF CONTRACT			1. Contract Number		Page of Pages		
					1 8		
2. Amendment/Modification Number Amendment No.3		3. Effective Date See Box 16C		4. Requisition/Purchase Request No. N/A		5. Solicitation Caption Construction Management and Inspection Services	
6. Issued by: Briana Vaden			Code		7. Administered by (If other than line 6)		
8. Name and Address of Contractor (No. street, city, county, state and zip code) TO ALL PROSPECTIVE OFFERORS Code Facility			9A. Amendment of Solicitation No. OCPTO23003		X		
			9B. Dated (See Item 11) June 23, 2023				
			10A. Modification of Contractor/Order No. N/A				
			10B. Dated (See Item 13) N/A				
11. THIS ITEM ONLY APPLIES TO AMENDMENTS OF SOLICITATIONS							
<input checked="" type="checkbox"/> The above numbered solicitation is amended as set forth in item 14. The hour and date specified for receipt of Offers <input checked="" type="checkbox"/> is extended. <input type="checkbox"/> is not extended. Offers must acknowledge receipt of this amendment prior to the hour and date specified in the solicitation or as amended, by one of the following methods: (a) By completing Items 8 and 15, and returning one (1) copy of the amendment: (b) By acknowledging receipt of this amendment on each copy of the offer submitted; or (c) By separate letter or fax which includes a reference to the solicitation and amendment number. FAILURE OF YOUR ACKNOWLEDGMENT TO BE RECEIVED AT THE PLACE DESIGNATED FOR THE RECEIPT OF OFFERS PRIOR TO THE HOUR AND DATE SPECIFIED MAY RESULT IN REJECTION OF YOUR OFFER. If by virtue of this amendment you desire to change an offer already submitted, such may be made by letter or fax, provided each letter or telegram makes reference to the solicitation and this amendment, and is received prior to the opening hour and date specified.							
12. Accounting and Appropriation Data (If Required)							
13. THIS ITEM APPLIES ONLY TO MODIFICATIONS OF CONTRACTS/ORDERS , IT MODIFIES THE CONTRACT/ORDER NO. AS DESCRIBED IN ITEM 14							
A. This change order is issued pursuant to (Specify Authority): 27 DCMR, Chapter 36, Section 3601.2(b) The changes set forth in Item 14 are made in the contract/order no. in item 10A.							
B. The above numbered contract/order is modified to reflect the administrative changes (such as changes in paying office, appropriation data etc.) set forth in item 14, pursuant to the authority of:							
C. This supplemental agreement is entered into pursuant to authority of: 27 DCMR 3601.2 Change Clause, 27 DCMR 2005.6(d) as amended							
x D. Other (Specify type of modification and authority) Paragraph 15, Changes, Standard Contract Provisions							
E. IMPORTANT: Contractor <input type="checkbox"/> is not <input checked="" type="checkbox"/> is required to sign this document and return one (1) copy to the issuing office.							
14. Description of Amendment/Modification (Organized by UCF Section headings, including solicitation/contract subject matter where feasible.) Solicitation No.: OCPTO23003 is hereby amended as follows: 1. Solicitation due date is extended to June 23, 2023 at 2:00PM. 2. Responses to bidders questions are as follows: Question#2: Timing and duration: What are the approximate anticipated start and end dates of this CM project? Response Q#2: Work will start immediately. There will be several locations/projects under the awarded contract. Question#3: DBE participation: Section 5.1 of the RFQ states "A 22.00% DBE <u>subcontracting</u> goal for firms certified as DBEs..." We are a DBE company ourselves and on other DDOT projects where we are the Prime consultant, we have been able to self-fulfill and exceed this percentage. Can we meet the DBE goal ourselves, or must it be through our <u>subcontractors</u> ONLY?							
Except as provided herein, all terms and conditions of the document is referenced in Item 9A or 10A remain unchanged and in full force and effect.							
15A. Contractor's Name and Title of Signer (Type or print)			16A. Name of Contracting Officer				
			Briana Vaden				
15B. Contractor/Vendor		15C. Date Signed		16B. District of Columbia		16C. Date Signed	
				Briana Vaden <i>Briana Vaden</i>		6/12/2023	
(Signature of person authorized to sign)			(Signature of Contracting Officer)				

AMENDMENT OF SOLICITATION / MODIFICATION OF CONTRACT			1. Contract Number		Page of Pages	
					2	8
2. Amendment/Modification Number Amendment No.3	3. Effective Date See Box 16C	4. Requisition/Purchase Request No. N/A	5. Solicitation Caption Construction Management and Inspection Services			

Response Q#3: The firm can self-perform up 15% of the DBE subcontracting goal.

Question#4 Have any completed designs and/or construction plans pertaining to the Bus Priority Program, Bicycle Lane Facility Program and Traffic Safety Improvements that are to be overseen by the Construction Manager selected under this particular RFQ been made available, and would DDOT/OCP please point us to them if so?

Response Q#4 Sample plans have been provided for bidders as reference only documents.

REG	STATE	PROJECT	SHEET NO.	TOTAL SHEETS
3	D.C.		58	107

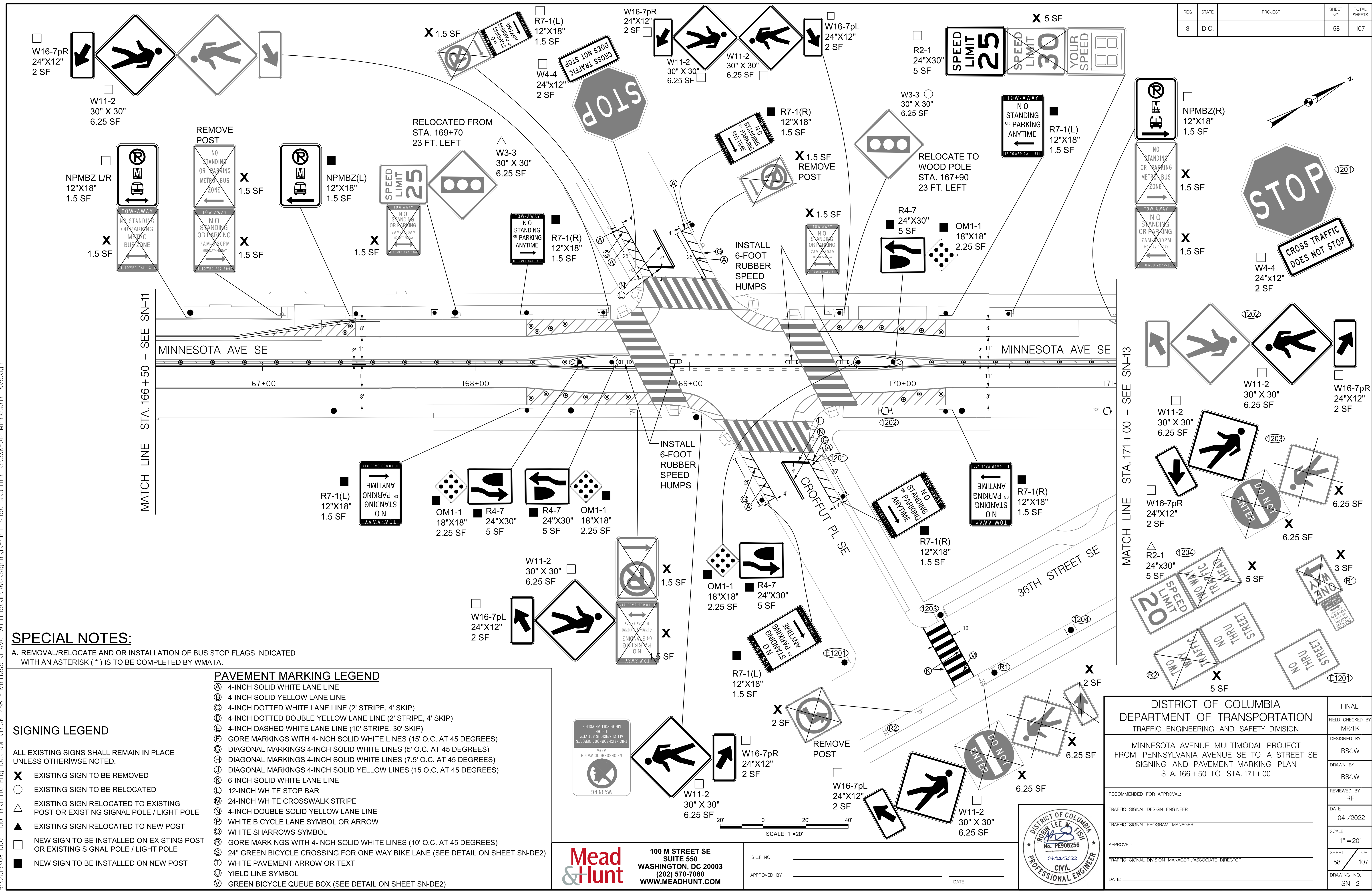

SPECIAL NOTES:

A. REMOVAL/RELOCATE AND OR INSTALLATION OF BUS STOP FLAGS INDICATED WITH AN ASTERISK (*) IS TO BE COMPLETED BY WMATA.

SIGNING LEGEND

- ALL EXISTING SIGNS SHALL REMAIN IN PLACE UNLESS OTHERWISE NOTED.
- X EXISTING SIGN TO BE REMOVED
 - EXISTING SIGN TO BE RELOCATED
 - △ EXISTING SIGN RELOCATED TO EXISTING POST OR EXISTING SIGNAL POLE / LIGHT POLE
 - ▲ EXISTING SIGN RELOCATED TO NEW POST
 - NEW SIGN TO BE INSTALLED ON EXISTING POST OR EXISTING SIGNAL POLE / LIGHT POLE
 - NEW SIGN TO BE INSTALLED ON NEW POST

PAVEMENT MARKING LEGEND

- Ⓐ 4-INCH SOLID WHITE LANE LINE
- Ⓑ 4-INCH SOLID YELLOW LANE LINE
- Ⓒ 4-INCH DOTTED WHITE LANE LINE (2' STRIPE, 4' SKIP)
- Ⓓ 4-INCH DOTTED DOUBLE YELLOW LANE LINE (2' STRIPE, 4' SKIP)
- Ⓔ 4-INCH DASHED WHITE LANE LINE (10' STRIPE, 30' SKIP)
- Ⓕ GORE MARKINGS WITH 4-INCH SOLID WHITE LINES (15' O.C. AT 45 DEGREES)
- Ⓖ DIAGONAL MARKINGS 4-INCH SOLID WHITE LINES (5' O.C. AT 45 DEGREES)
- Ⓗ DIAGONAL MARKINGS 4-INCH SOLID WHITE LINES (7.5' O.C. AT 45 DEGREES)
- Ⓙ DIAGONAL MARKINGS 4-INCH SOLID YELLOW LINES (15' O.C. AT 45 DEGREES)
- Ⓚ 6-INCH SOLID WHITE LANE LINE
- Ⓛ 12-INCH WHITE STOP BAR
- Ⓜ 24-INCH WHITE CROSSWALK STRIPE
- Ⓝ 4-INCH DOUBLE SOLID YELLOW LANE LINE
- Ⓟ WHITE BICYCLE LANE SYMBOL OR ARROW
- Ⓠ WHITE SHARROWS SYMBOL
- Ⓡ GORE MARKINGS WITH 4-INCH SOLID WHITE LINES (10' O.C. AT 45 DEGREES)
- Ⓢ 24" GREEN BICYCLE CROSSING FOR ONE WAY BIKE LANE (SEE DETAIL ON SHEET SN-DE2)
- Ⓣ WHITE PAVEMENT ARROW OR TEXT
- Ⓤ YIELD LINE SYMBOL
- Ⓡ GREEN BICYCLE QUEUE BOX (SEE DETAIL ON SHEET SN-DE2)

Mead & Hunt
 100 M STREET SE SUITE 550
 WASHINGTON, DC 20003
 (202) 570-7080
 WWW.MEADHUNT.COM

S.I.F. NO. _____
 APPROVED BY _____ DATE _____



DISTRICT OF COLUMBIA DEPARTMENT OF TRANSPORTATION TRAFFIC ENGINEERING AND SAFETY DIVISION		FINAL
MINNESOTA AVENUE MULTIMODAL PROJECT FROM PENNSYLVANIA AVENUE SE TO A STREET SE SIGNING AND PAVEMENT MARKING PLAN STA. 166+50 TO STA. 171+00		FIELD CHECKED BY MP/TK
DESIGNED BY BS/JW	DRAWN BY BS/JW	REVIEWED BY RF
RECOMMENDED FOR APPROVAL:	DATE 04 /2022	SCALE 1" = 20'
TRAFFIC SIGNAL DESIGN ENGINEER	APPROVED:	SHEET 58 OF 107
TRAFFIC SIGNAL PROGRAM MANAGER	DATE:	DRAWING NO. SN-12
TRAFFIC SIGNAL DIVISION MANAGER / ASSOCIATE DIRECTOR		

4/1/2022 R:\2019\08_0010_Traffic_Eng_Des_JMT\Task_25B - Minnesota Ave Multimodal\DWG\Signing\Print_Sheets\JMT\012_Minnesota_Ave.dgn

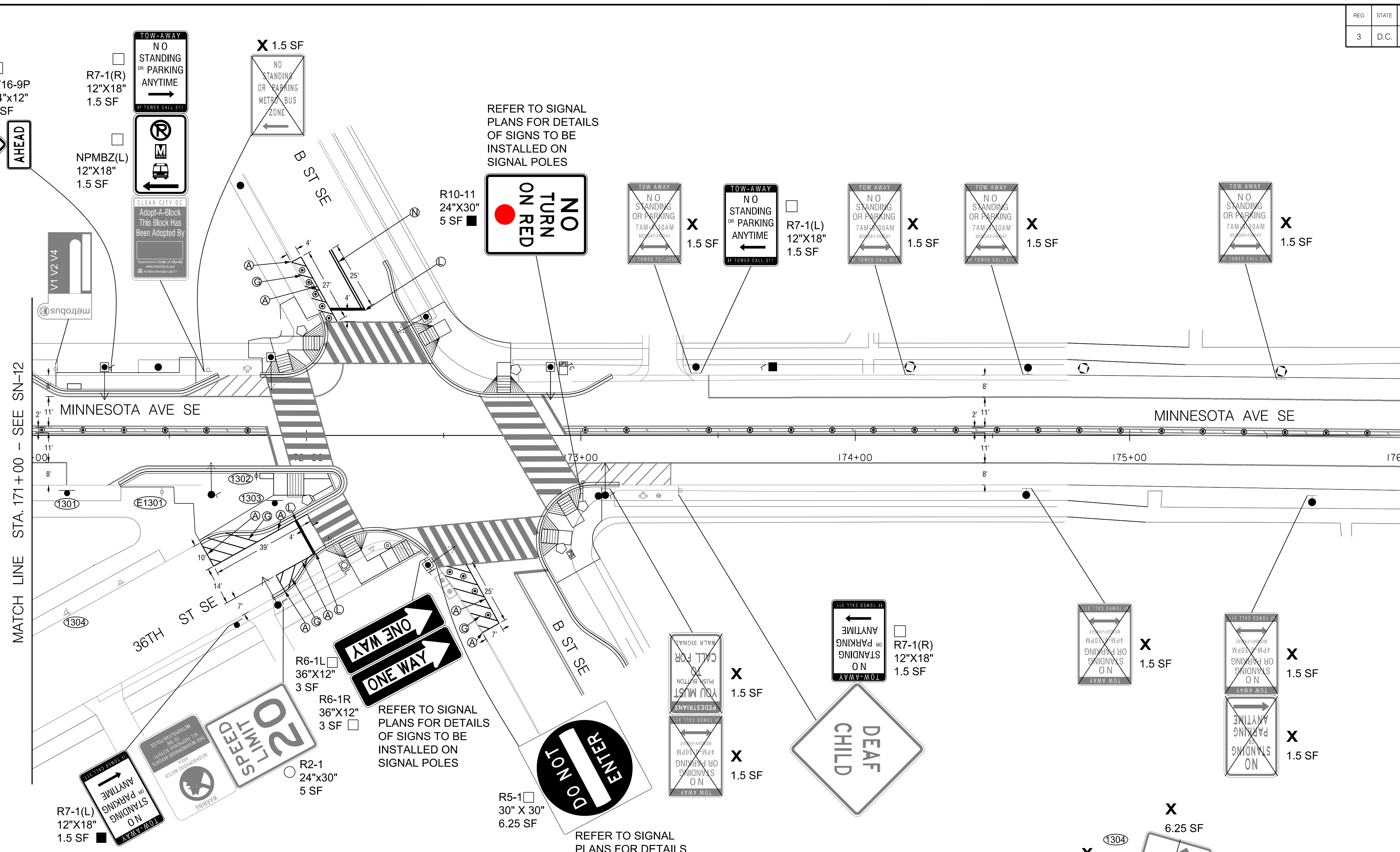
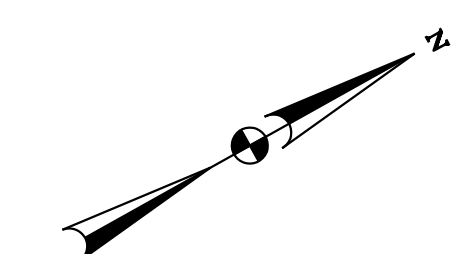

MATCH LINE STA. 171+00 - SEE SN-12

MATCH LINE STA. 176+00 - SEE SN-14

SIGNING LEGEND

- ALL EXISTING SIGNS SHALL REMAIN IN PLACE UNLESS OTHERWISE NOTED.
- X EXISTING SIGN TO BE REMOVED
 - EXISTING SIGN TO BE RELOCATED
 - △ EXISTING SIGN RELOCATED TO EXISTING POST OR EXISTING SIGNAL POLE / LIGHT POLE
 - ▲ EXISTING SIGN RELOCATED TO NEW POST
 - NEW SIGN TO BE INSTALLED ON EXISTING POST OR EXISTING SIGNAL POLE / LIGHT POLE
 - NEW SIGN TO BE INSTALLED ON NEW POST

PAVEMENT MARKING LEGEND

- Ⓐ 4-INCH SOLID WHITE LANE LINE
- Ⓑ 4-INCH SOLID YELLOW LANE LINE
- Ⓒ 4-INCH DOTTED WHITE LANE LINE (2' STRIPE, 4' SKIP)
- Ⓓ 4-INCH DOTTED DOUBLE YELLOW LANE LINE (2' STRIPE, 4' SKIP)
- Ⓔ 4-INCH DASHED WHITE LANE LINE (10' STRIPE, 30' SKIP)
- Ⓕ GORE MARKINGS WITH 4-INCH SOLID WHITE LINES (15' O.C. AT 45 DEGREES)
- Ⓖ DIAGONAL MARKINGS 4-INCH SOLID WHITE LINES (5' O.C. AT 45 DEGREES)
- Ⓗ DIAGONAL MARKINGS 4-INCH SOLID WHITE LINES (7.5' O.C. AT 45 DEGREES)
- Ⓙ DIAGONAL MARKINGS 4-INCH SOLID YELLOW LINES (15' O.C. AT 45 DEGREES)
- Ⓚ 6-INCH SOLID WHITE LANE LINE
- Ⓛ 12-INCH WHITE STOP BAR
- Ⓜ 24-INCH WHITE CROSSWALK STRIPE
- Ⓝ 4-INCH DOUBLE SOLID YELLOW LANE LINE
- Ⓟ WHITE BICYCLE LANE SYMBOL OR ARROW
- Ⓠ WHITE SHARROWS SYMBOL
- Ⓡ GORE MARKINGS WITH 4-INCH SOLID WHITE LINES (10' O.C. AT 45 DEGREES)
- Ⓢ 24" GREEN BICYCLE CROSSING FOR ONE WAY BIKE LANE (SEE DETAIL ON SHEET SN-DE2)
- Ⓣ WHITE PAVEMENT ARROW OR TEXT
- Ⓤ YIELD LINE SYMBOL
- Ⓡ GREEN BICYCLE QUEUE BOX (SEE DETAIL ON SHEET SN-DE2)

REFER TO SIGNAL PLANS FOR DETAILS OF SIGNS TO BE INSTALLED ON SIGNAL POLES

SPECIAL NOTES:

- A. REMOVAL/RELOCATE AND OR INSTALLATION OF BUS STOP FLAGS INDICATED WITH AN ASTERISK (*) IS TO BE COMPLETED BY WMATA.

Mead & Hunt
 100 M STREET SE SUITE 550
 WASHINGTON, DC 20003
 (202) 570-7080
 WWW.MEADHUNT.COM

S.I.F. NO. _____
 APPROVED BY _____ DATE _____



DISTRICT OF COLUMBIA
 DEPARTMENT OF TRANSPORTATION
 TRAFFIC ENGINEERING AND SAFETY DIVISION

MINNESOTA AVENUE MULTIMODAL PROJECT
 FROM PENNSYLVANIA AVENUE SE TO A STREET SE
 SIGNING AND PAVEMENT MARKING PLAN
 STA. 171+00 TO STA. 176+00

RECOMMENDED FOR APPROVAL:	FINAL
TRAFFIC SIGNAL DESIGN ENGINEER	FIELD CHECKED BY
TRAFFIC SIGNAL PROGRAM MANAGER	MP/K
APPROVED:	DESIGNED BY
TRAFFIC SIGNAL DIVISION MANAGER / ASSOCIATE DIRECTOR	BS/JW
DATE:	DRAWN BY
	BS/JW
	REVIEWED BY
	RF
	DATE
	04 /2022
	SCALE
	1" = 20'
	SHEET
	59
	OF
	107
	DRAWING NO.
	SN-13

4/1/2022 R:\2019\08 DD01 ID0 Traffic Eng Des JMT\Task 258 - Minnesota Ave Multimodal\DWG\Signing\Print_Sheets\JMT\Task 258 - Minnesota Ave Multimodal\DWG\Signing\Print_Sheets\JMT\Task 258 - Minnesota Ave.dgn

P:\80580-citywide engineering by no.3\working-temp\work_order_38 & 39 - near nw 11th street a street and rhode island avenue nw\PSN-P001-80580-38-11th st. q st and rhode island ave nw.dgn
5/8/2023

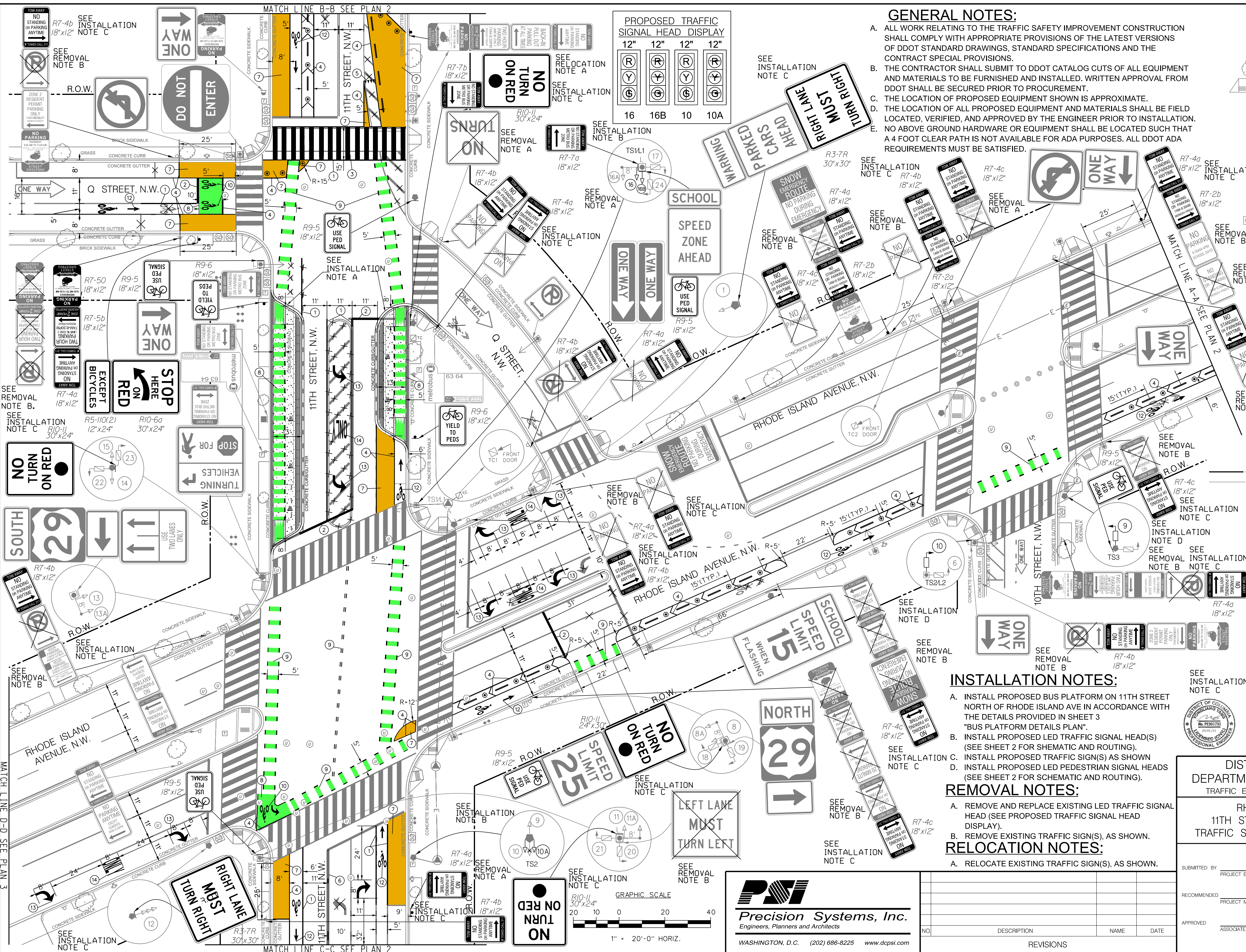

GENERAL NOTES:

- A. ALL WORK RELATING TO THE TRAFFIC SAFETY IMPROVEMENT CONSTRUCTION SHALL COMPLY WITH APPROPRIATE PROVISIONS OF THE LATEST VERSIONS OF DDOT STANDARD DRAWINGS, STANDARD SPECIFICATIONS AND THE CONTRACT SPECIAL PROVISIONS.
- B. THE CONTRACTOR SHALL SUBMIT TO DDOT CATALOG CUTS OF ALL EQUIPMENT AND MATERIALS TO BE FURNISHED AND INSTALLED. WRITTEN APPROVAL FROM DDOT SHALL BE SECURED PRIOR TO PROCUREMENT.
- C. THE LOCATION OF PROPOSED EQUIPMENT SHOWN IS APPROXIMATE.
- D. THE LOCATION OF ALL PROPOSED EQUIPMENT AND MATERIALS SHALL BE FIELD LOCATED, VERIFIED, AND APPROVED BY THE ENGINEER PRIOR TO INSTALLATION.
- E. NO ABOVE GROUND HARDWARE OR EQUIPMENT SHALL BE LOCATED SUCH THAT A 4 FOOT CLEAR PATH IS NOT AVAILABLE FOR ADA PURPOSES. ALL DDOT ADA REQUIREMENTS MUST BE SATISFIED.

LEGEND:

- ⊙ EXISTING TREE OR SHRUB
- ⚠ EXISTING WHEELCHAIR RAMP
- ⚠ EXISTING TRAFFIC SIGN AND/OR POST
- ⚠ PROPOSED TRAFFIC SIGN AND/OR POST
- ⚠ EXISTING BUS STOP SIGN AND POST
- ⊙ EXISTING FLEXIBLE DELINEATOR POST
- ⊙ PROPOSED FLEXIBLE DELINEATOR POST
- ⊙ EXISTING FIRE HYDRANT
- ⊙ EXISTING UNKNOWN MANHOLE
- ⊙ EXISTING PEPCO ELECTRICAL MANHOLE
- ⊙ EXISTING DDOT MANHOLE
- ⊙ EXISTING CATCH BASIN
- ⊙ EXISTING TRAFFIC SIGNAL CONTROL
- ⊙ EXISTING #16 STREETLIGHT POLE
- ⊙ EXISTING 28-FOOT PENDANT POST
- ⊙ STREETLIGHT POLE WITH A TRANSFORMER BASE AND LUMINAIRE
- ⊙ EXISTING 20-FOOT STEEL TRAFFIC SIGNAL POLE WITH A TRANSFORMER BASE
- ⊙ EXISTING AD-11 TRAFFIC SIGNAL POLE
- ⊙ EXISTING 3-SECTION LED TRAFFIC SIGNAL HEAD CONVENTIONAL (ALL LENSES 12 INCHES)
- ⊙ PROPOSED 3-SECTION LED TRAFFIC SIGNAL HEAD CONVENTIONAL (ALL LENSES 12 INCHES)
- ⊙ PROPOSED 2-SECTION LED COUNT-DOWN PEDESTRIAN SIGNAL HEAD
- ⊙ EXISTING LUMINAIRE AND SUPPORT ARM INDICATING DIRECTION OF LIGHT
- ⊙ EXISTING ITEM TO BE REMOVED
- ⊙ PROPOSED WHEELSTOPS
- ⊙ R.O.W. RIGHT OF WAY LINE
- ⊙ EXISTING ELECTRIC LINE

PAVEMENT MARKING LEGEND

- ① 6" SINGLE WHITE LINE
- ② 12" SINGLE WHITE LINE
- ③ 24" SINGLE WHITE LINE
- ④ 4" SINGLE WHITE LINE
- ⑤ 12" x 18" YIELD MARKINGS
- ⑥ 4" DOUBLE YELLOW LINE
- ⑦ TAN PAINT
- ⑧ GREEN PAINT
- ⑨ GREEN PAINT BOUNDED BY 6" WHITE, 2' - 4' SKIP LINE
- ⑩ 8" BICYCLE SYMBOL
- ⑪ 12" BICYCLE SHARROW
- ⑫ 8" BICYCLE SYMBOL WITH 6" ARROW, SPACED 6' APART
- ⑬ 8" ARROW
- ⑭ 8" PAVEMENT MARKING TEXT
- ⑮ DOUBLE YELLOW 4" WIDE, 2' DASHED PAVEMENT MARKING WITH 4" GAP INTERSECTION CENTER GUIDE LINES

INSTALLATION NOTES:

- A. INSTALL PROPOSED BUS PLATFORM ON 11TH STREET NORTH OF RHODE ISLAND AVE IN ACCORDANCE WITH THE DETAILS PROVIDED IN SHEET 3 "BUS PLATFORM DETAILS PLAN".
- B. INSTALL PROPOSED LED TRAFFIC SIGNAL HEAD(S) (SEE SHEET 2 FOR SCHEMATIC AND ROUTING).
- C. INSTALL PROPOSED TRAFFIC SIGN(S) AS SHOWN
- D. INSTALL PROPOSED LED PEDESTRIAN SIGNAL HEADS (SEE SHEET 2 FOR SCHEMATIC AND ROUTING).

REMOVAL NOTES:

- A. REMOVE AND REPLACE EXISTING LED TRAFFIC SIGNAL HEAD (SEE PROPOSED TRAFFIC SIGNAL HEAD DISPLAY).
- B. REMOVE EXISTING TRAFFIC SIGN(S), AS SHOWN.

RELOCATION NOTES:

- A. RELOCATE EXISTING TRAFFIC SIGN(S), AS SHOWN.

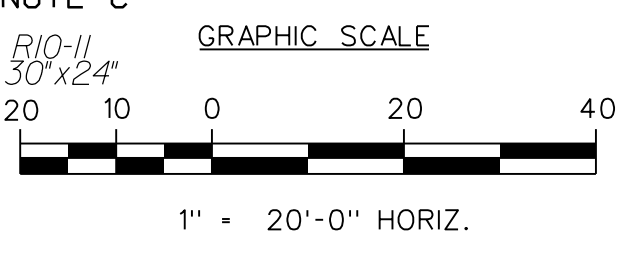
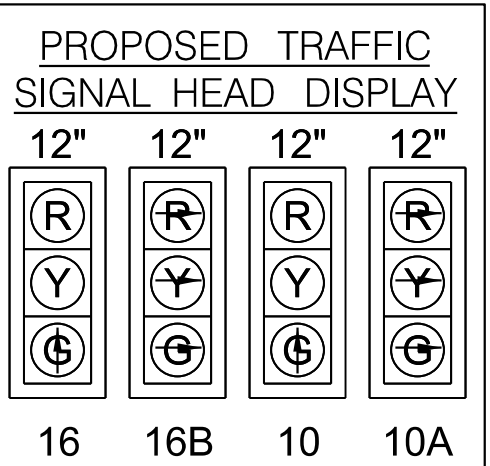

Precision Systems, Inc.
Engineers, Planners and Architects
WASHINGTON, D.C. (202) 686-8225 www.dcps.com

NO.	DESCRIPTION	NAME	DATE

DISTRICT OF COLUMBIA
DEPARTMENT OF TRANSPORTATION
TRAFFIC ENGINEERING AND SAFETY DIVISION

RHODE ISLAND AVENUE,
11TH STREET, AND Q STREET, N.W.
TRAFFIC SAFETY IMPROVEMENT PLAN - 1

SUBMITTED BY	PROJECT ENGINEER	DATE	05 / 23
RECOMMENDED BY	PROJECT MANAGER	DATE	
APPROVED BY	ASSOCIATE DIRECTOR, TESD	DATE	

FINAL
FIELD CHECKED BY: RB / AYY
DESIGNED BY: AYY
DRAWN BY: UA / SZ
REVIEWED BY: AYY

SCALE: 1" = 20'
SHEET 1 OF 4
DRAWING NO. SN-01

P:\80580-citywide engineering by no.3\working-temp\work_order_38 & 39 - near nw 11th street and rhode island avenue n.w\SN-P002-80580-38-11th st, q st and rhode island ave n.w.dgn
5/8/2023

PROPOSED SIGN SCHEDULE

R7-5a 18"x12" QUANTITY: 2	R7-5b 18"x12" QUANTITY: 2	R7-5c 18"x12" QUANTITY: 1	R7-5b (2) 18"x12" QUANTITY: 1	R7-50 18"x12" QUANTITY: 1	R7-4a 18"x12" QUANTITY: 13	R7-4b 18"x12" QUANTITY: 11	R7-4c 18"x12" QUANTITY: 8	R7-2a 18"x12" QUANTITY: 1	R7-2b 18"x12" QUANTITY: 2	R7-7a 18"x12" QUANTITY: 1

R7-7b 18"x12" QUANTITY: 1	R9-6 18"x12" QUANTITY: 2	R10-11 30"x24" QUANTITY: 4	R3-7R 30"x30" QUANTITY: 2	R10-6a 30"x24" QUANTITY: 1

R9-5 18"x12" QUANTITY: 5	R5-110(2) 12"x24" QUANTITY: 1

GENERAL NOTES:

- ALL WORK RELATING TO THE TRAFFIC SAFETY IMPROVEMENT CONSTRUCTION SHALL COMPLY WITH APPROPRIATE PROVISIONS OF THE LATEST VERSIONS OF DDOT STANDARD DRAWINGS, STANDARD SPECIFICATIONS AND THE CONTRACT SPECIAL PROVISIONS.
- THE CONTRACTOR SHALL SUBMIT TO DDOT CATALOG CUTS OF ALL EQUIPMENT AND MATERIALS TO BE FURNISHED AND INSTALLED. WRITTEN APPROVAL FROM DDOT SHALL BE SECURED PRIOR TO PROCUREMENT.
- THE LOCATION OF PROPOSED EQUIPMENT SHOWN IS APPROXIMATE.
- THE LOCATION OF ALL PROPOSED EQUIPMENT AND MATERIALS SHALL BE FIELD LOCATED, VERIFIED, AND APPROVED BY THE ENGINEER PRIOR TO INSTALLATION.
- NO ABOVE GROUND HARDWARE OR EQUIPMENT SHALL BE LOCATED SUCH THAT A 4 FOOT CLEAR PATH IS NOT AVAILABLE FOR ADA PURPOSES. ALL DDOT ADA REQUIREMENTS MUST BE SATISFIED.

INSTALLATION NOTES:

- INSTALL PROPOSED BUS PLATFORM ON 11TH STREET NORTH OF RHODE ISLAND AVE IN ACCORDANCE WITH THE DETAILS PROVIDED IN SHEET 3 "BUS PLATFORM DETAILS PLAN".
- INSTALL PROPOSED LED TRAFFIC SIGNAL HEAD(S) (SEE SHEET 2 FOR SCHEMATIC AND ROUTING).
- INSTALL PROPOSED TRAFFIC SIGN(S) AS SHOWN
- INSTALL PROPOSED LED PEDESTRIAN SIGNAL HEADS (SEE SHEET 2 FOR SCHEMATIC AND ROUTING).

REMOVAL NOTES:

- REMOVE AND REPLACE EXISTING LED TRAFFIC SIGNAL HEAD (SEE PROPOSED TRAFFIC SIGNAL HEAD DISPLAY).
- REMOVE EXISTING TRAFFIC SIGN(S), AS SHOWN.

RELOCATION NOTES:

- RELOCATE EXISTING TRAFFIC SIGN(S), AS SHOWN.

LEGEND:

- EXISTING TREE OR SHRUB
- EXISTING WHEELCHAIR RAMP
- EXISTING TRAFFIC SIGN AND/OR POST
- PROPOSED TRAFFIC SIGN AND/OR POST
- EXISTING BUS STOP SIGN AND POST
- EXISTING FLEXIBLE DELINEATOR POST
- PROPOSED FLEXIBLE DELINEATOR POST
- EXISTING FIRE HYDRANT
- EXISTING UNKNOWN MANHOLE
- EXISTING PEPCO ELECTRICAL MANHOLE
- EXISTING DDOT MANHOLE
- EXISTING CATCH BASIN
- EXISTING TRAFFIC SIGNAL CONTROL
- EXISTING #16 STREETLIGHT POLE
- EXISTING 28-FOOT PENDANT POST STREETLIGHT POLE WITH A TRANSFORMER BASE AND LUMINAIRE
- EXISTING 20-FOOT STEEL TRAFFIC SIGNAL POLE WITH A TRANSFORMER BASE
- EXISTING AD-11 TRAFFIC SIGNAL POLE
- EXISTING 3-SECTION LED TRAFFIC SIGNAL HEAD CONVENTIONAL (ALL LENSES 12 INCHES)
- PROPOSED 3-SECTION LED TRAFFIC SIGNAL HEAD CONVENTIONAL (ALL LENSES 12 INCHES)
- PROPOSED 2-SECTION LED COUNT-DOWN PEDESTRIAN SIGNAL HEAD
- EXISTING LUMINAIRE AND SUPPORT ARM INDICATING DIRECTION OF LIGHT
- EXISTING ITEM TO BE REMOVED
- PROPOSED WHEELSTOPS
- RIGHT OF WAY LINE
- EXISTING ELECTRIC LINE

ALL PROPOSED PAVEMENT MARKING SHALL BE THERMOPLASTIC UNLESS OTHERWISE LABELED

PAVEMENT MARKING LEGEND

- ① 6" SINGLE WHITE LINE
- ② 12" SINGLE WHITE LINE
- ③ 24" SINGLE WHITE LINE
- ④ 4" SINGLE WHITE LINE
- ⑤ 12" x 18" YIELD MARKINGS
- ⑥ 4" DOUBLE YELLOW LINE
- ⑦ TAN PAINT
- ⑧ GREEN PAINT
- ⑨ GREEN PAINT BOUNDED BY 6" WHITE, 2' - 4' SKIP LINE
- ⑩ 8" BICYCLE SYMBOL
- ⑪ 12" BICYCLE SHARROW
- ⑫ 8" BICYCLE SYMBOL WITH 6" ARROW, SPACED 6' APART
- ⑬ 8" ARROW
- ⑭ 8" PAVEMENT MARKING TEXT

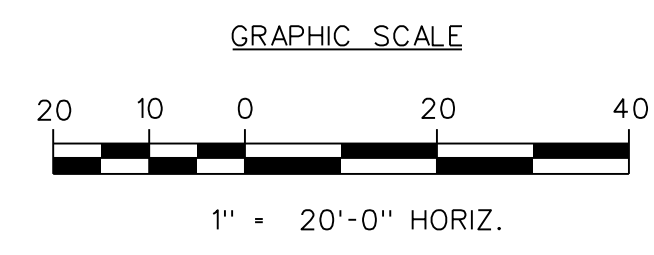
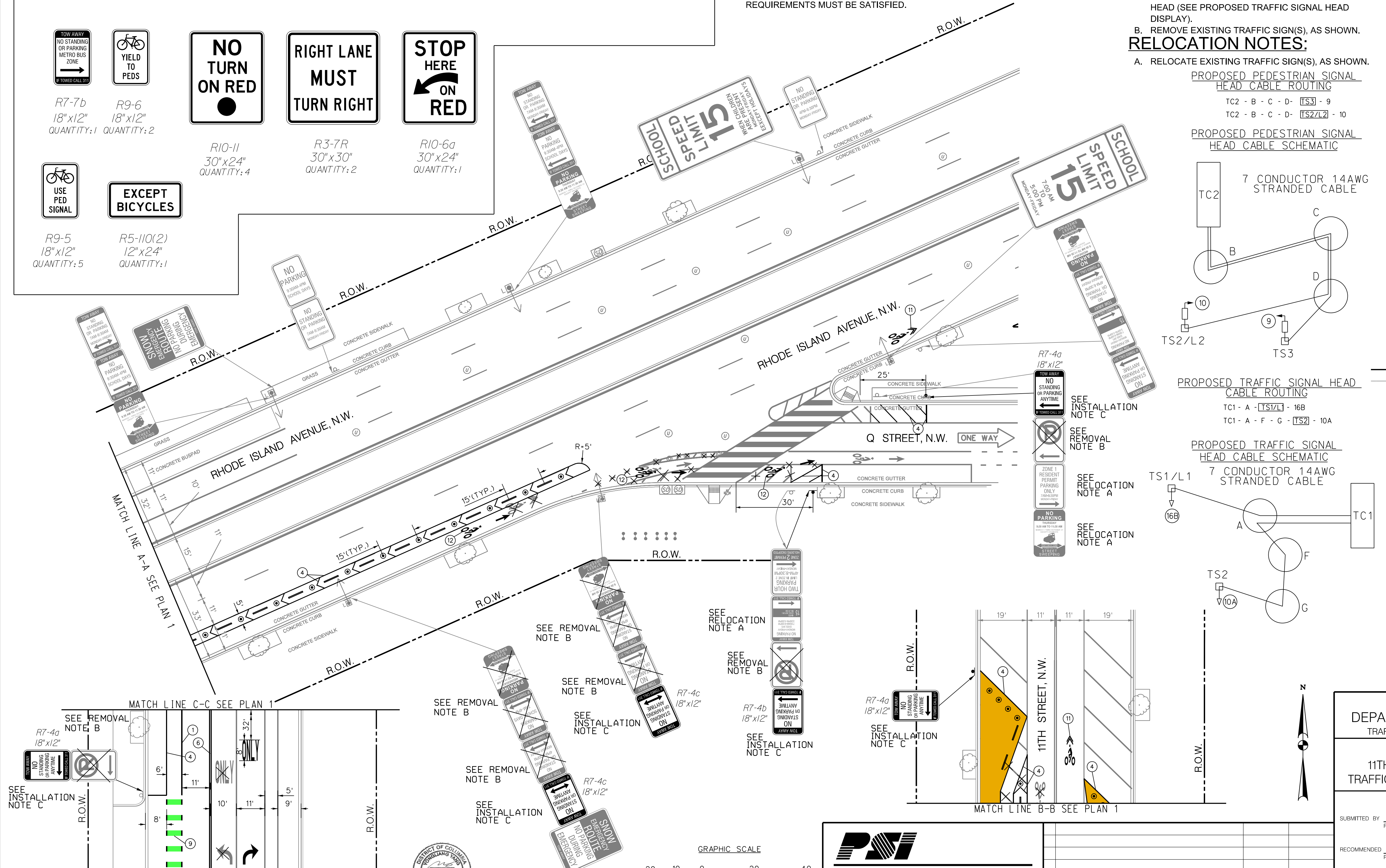

Precision Systems, Inc.
Engineers, Planners and Architects
WASHINGTON, D.C. (202) 686-8225 www.dcps.com

NO.	DESCRIPTION	NAME	DATE

DISTRICT OF COLUMBIA DEPARTMENT OF TRANSPORTATION TRAFFIC ENGINEERING AND SAFETY DIVISION		FINAL
RHODE ISLAND AVENUE, 11TH STREET, AND Q STREET, N.W. TRAFFIC SAFETY IMPROVEMENT PLAN - 2		FIELD CHECKED BY RB / AYY
DESIGNED BY Ayy		DATE 05 / 23
DRAWN BY UA / SZ		SCALE 1" = 20'
REVIEWED BY Ayy		SHEET 2 OF 4
DRAWING NO. SN-02		
SUBMITTED BY PROJECT ENGINEER	DATE	
RECOMMENDED BY PROJECT MANAGER	DATE	
APPROVED BY ASSOCIATE DIRECTOR, TESD	DATE	

REG	STATE	PROJECT	SHEET NO.	TOTAL SHEETS
	D.C.			

LEGEND:

- EXISTING TREE OR SHRUB
- EXISTING WHEELCHAIR RAMP
- EXISTING TRAFFIC SIGN AND/OR POST
- PROPOSED TRAFFIC SIGN AND/OR POST
- EXISTING BUS STOP SIGN AND POST
- EXISTING FLEXIBLE DELINEATOR POST
- PROPOSED FLEXIBLE DELINEATOR POST
- EXISTING FIRE HYDRANT
- EXISTING UNKNOWN MANHOLE
- EXISTING PEPSCO ELECTRICAL MANHOLE
- EXISTING DDOT MANHOLE
- EXISTING CATCH BASIN
- EXISTING TRAFFIC SIGNAL CONTROL
- EXISTING #16 STREETLIGHT POLE
- EXISTING 28-FOOT PENDANT POST
- EXISTING 20-FOOT STEEL TRAFFIC SIGNAL POLE WITH A TRANSFORMER BASE AND LUMINAIRE
- EXISTING AD-11 TRAFFIC SIGNAL POLE
- EXISTING 3-SECTION LED TRAFFIC SIGNAL HEAD CONVENTIONAL (ALL LENSES 12 INCHES)
- PROPOSED 3-SECTION LED TRAFFIC SIGNAL HEAD CONVENTIONAL (ALL LENSES 12 INCHES)
- PROPOSED 2-SECTION LED COUNT-DOWN PEDESTRIAN SIGNAL HEAD
- EXISTING LUMINAIRE AND SUPPORT ARM INDICATING DIRECTION OF LIGHT
- EXISTING ITEM TO BE REMOVED
- PROPOSED WHEELSTOPS
- RIGHT OF WAY LINE
- EXISTING ELECTRIC LINE

GENERAL NOTES:

ALL WORK RELATING TO THE TRAFFIC SAFETY IMPROVEMENT CONSTRUCTION SHALL COMPLY WITH APPROPRIATE PROVISIONS OF THE LATEST VERSIONS OF DDOT STANDARD DRAWINGS, STANDARD SPECIFICATIONS AND THE CONTRACT SPECIAL PROVISIONS.

THE CONTRACTOR SHALL SUBMIT TO DDOT CATALOG CUTS OF ALL EQUIPMENT AND MATERIALS TO BE FURNISHED AND INSTALLED. WRITTEN APPROVAL FROM DDOT SHALL BE SECURED PRIOR TO PROCUREMENT.

THE LOCATION OF PROPOSED EQUIPMENT SHOWN IS APPROXIMATE. THE LOCATION OF ALL PROPOSED EQUIPMENT AND MATERIALS SHALL BE FIELD LOCATED, VERIFIED, AND APPROVED BY THE ENGINEER PRIOR TO INSTALLATION. NO ABOVE GROUND HARDWARE OR EQUIPMENT SHALL BE LOCATED SUCH THAT A 4 FOOT CLEAR PATH IS NOT AVAILABLE FOR ADA PURPOSES. ALL DDOT ADA REQUIREMENTS MUST BE SATISFIED.

INSTALLATION NOTES:

- A. INSTALL PROPOSED BUS PLATFORM ON 11TH STREET NORTH OF RHODE ISLAND AVE IN ACCORDANCE WITH THE DETAILS PROVIDED IN SHEET 3 "BUS PLATFORM DETAILS PLAN".
- B. INSTALL PROPOSED LED TRAFFIC SIGNAL HEAD(S) (SEE SHEET 2 FOR SCHEMATIC AND ROUTING).
- C. INSTALL PROPOSED TRAFFIC SIGN(S) AS SHOWN
- D. INSTALL PROPOSED LED PEDESTRIAN SIGNAL HEADS (SEE SHEET 2 FOR SCHEMATIC AND ROUTING).

REMOVAL NOTES:

- A. REMOVE AND REPLACE EXISTING LED TRAFFIC SIGNAL HEAD (SEE PROPOSED TRAFFIC SIGNAL HEAD DISPLAY).
- B. REMOVE EXISTING TRAFFIC SIGN(S), AS SHOWN.

RELOCATION NOTES:

- A. RELOCATE EXISTING TRAFFIC SIGN(S), AS SHOWN.

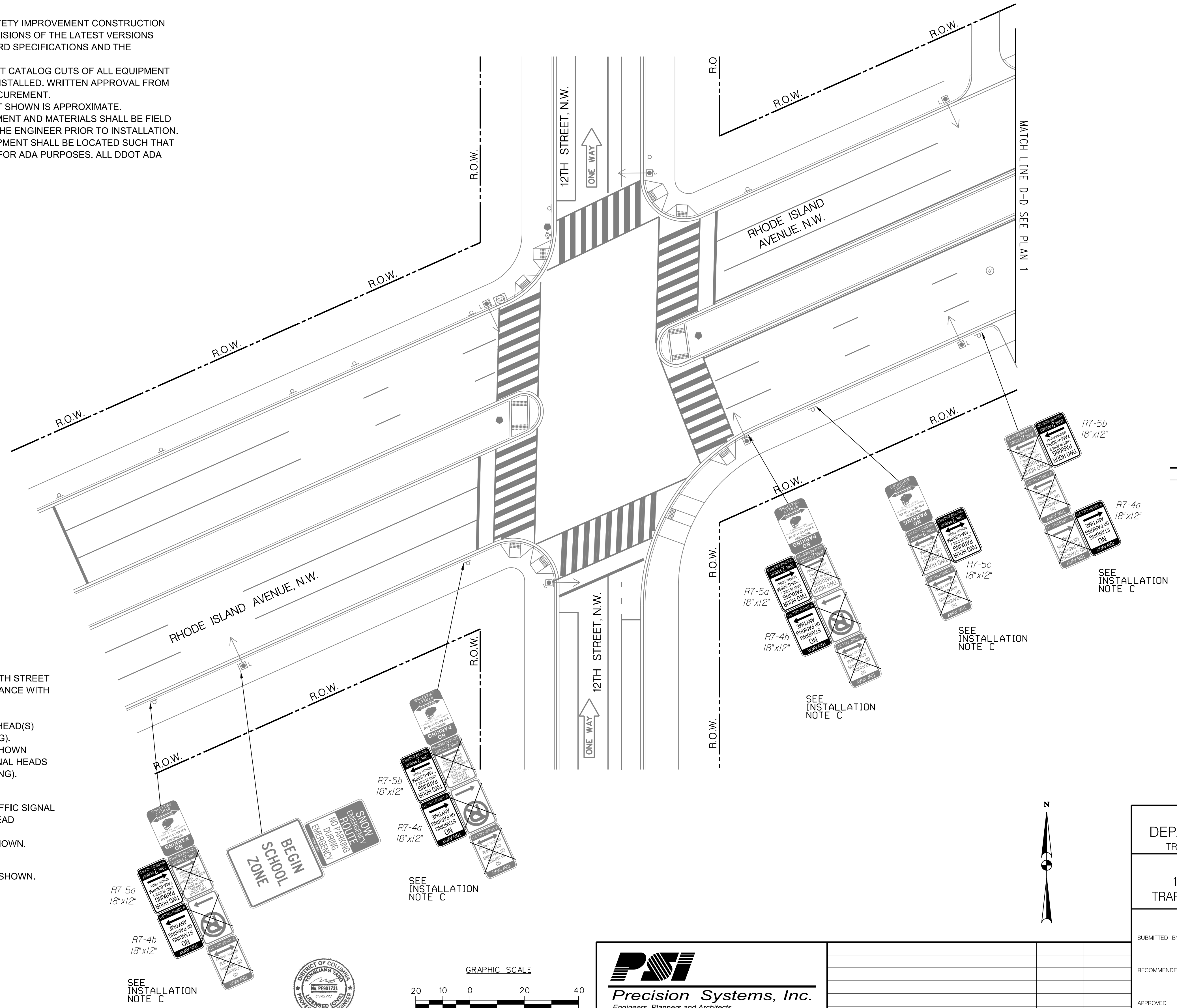

P:\80580-citywide engineering by no3\working-temp\work_order_38 & 39 - near nw 11th street a street and rhode island avenue nw\DN-P003-80580-38-11th st, q st and rhode island ave nw.dgn 5/8/2023 9:51:53 AM

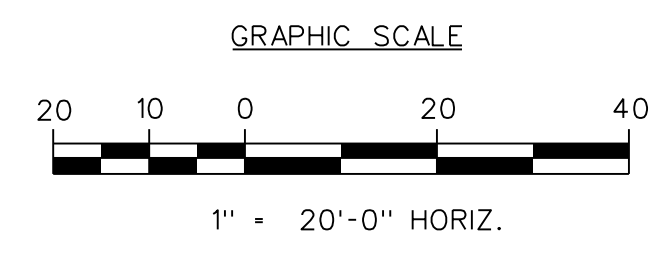
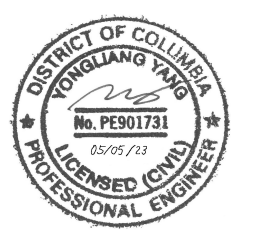

Precision Systems, Inc.
 Engineers, Planners and Architects
 WASHINGTON, D.C. (202) 686-8225 www.dcpsl.com

NO.	DESCRIPTION	NAME	DATE
REVISIONS			

DISTRICT OF COLUMBIA DEPARTMENT OF TRANSPORTATION TRAFFIC ENGINEERING AND SAFETY DIVISION		FINAL
RHODE ISLAND AVENUE, 11TH STREET, AND Q STREET, N.W. TRAFFIC SAFETY IMPROVEMENT PLAN - 3		FIELD CHECKED BY RB /AYY
DESIGNED BY AYY		DRAWN BY UA /SZ
REVIEWED BY AYY		DATE 05 /23
SUBMITTED BY PROJECT ENGINEER	DATE	SCALE 1" = 20'
RECOMMENDED PROJECT MANAGER	DATE	SHEET 3 OF 4
APPROVED ASSOCIATE DIRECTOR, TESD	DATE	DRAWING NO. SN-03

REG	STATE	PROJECT	SHEET NO.	TOTAL SHEETS
	D.C.			

BUS PLATFORM DETAILS - 11TH STREET
NORTH OF RHODE ISLAND AVENUE



11TH STREET BUS PLATFORM			
POINT	STATION	OFFSET	ELEVATION
E1	1+24.44	30.00LT	85.21
E2	1+28.60	28.33LT	85.69
E3	1.33.97	19.50LT	85.94
E4	1+39.17	16.50LT	85.95
E5	2+25.49	16.50LT	85.33
E6	2+30.67	19.50LT	85.12
E7	2+35.02	27.00LT	84.84
E8	2+40.21	30.00LT	84.14
E9	1+69.19	30.00RT	84.18
E10	1+74.39	27.00RT	85.15
E11	1+78.72	19.50RT	85.47
E12	1+83.91	16.50RT	85.51
E13	2+21.18	16.50RT	85.39
E14	2+30.11	36.52RT	84.36
E15	2+23.28	44.12RT	84.15

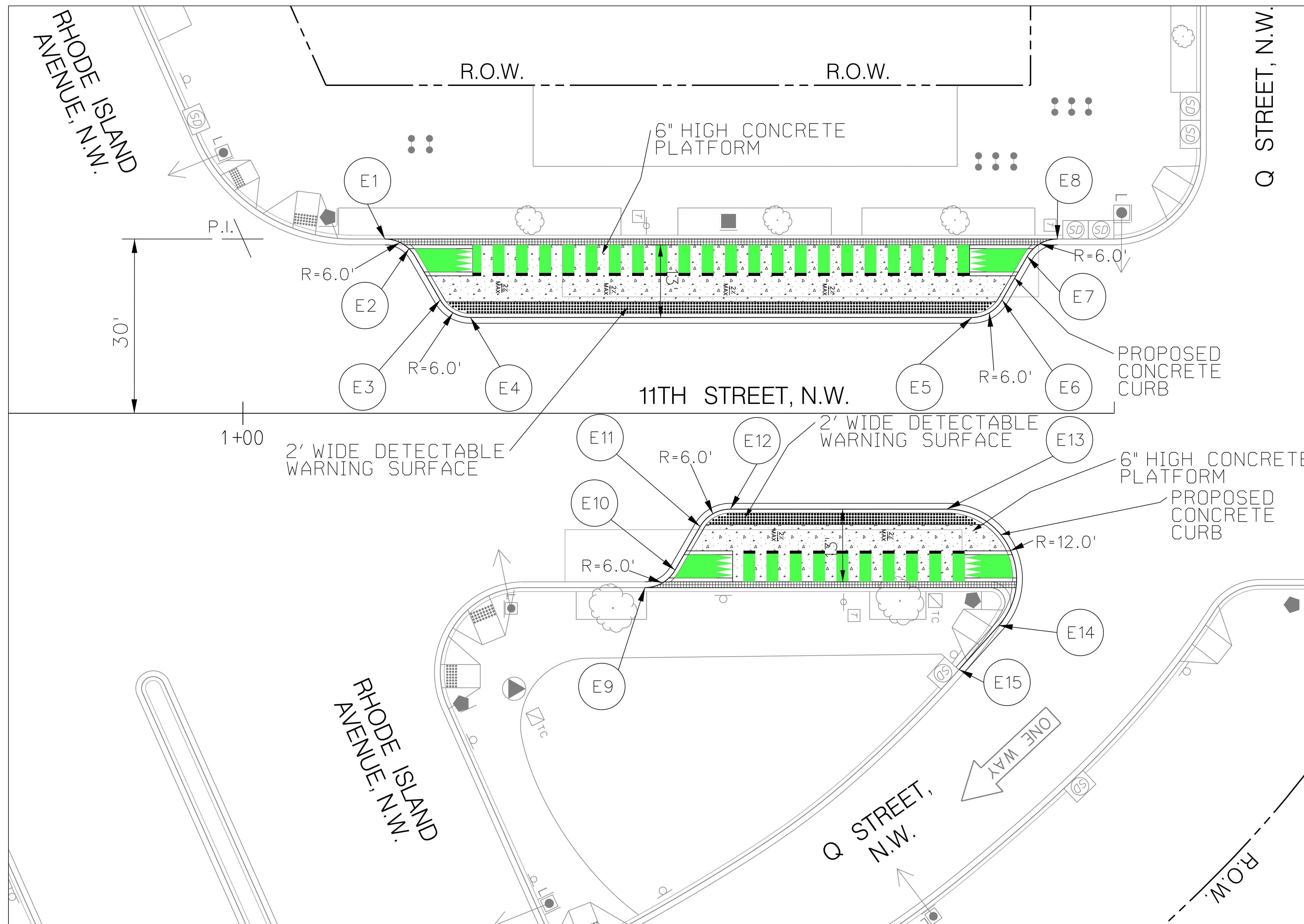

RHODE ISLAND AVENUE, N.W.

Q STREET, N.W.

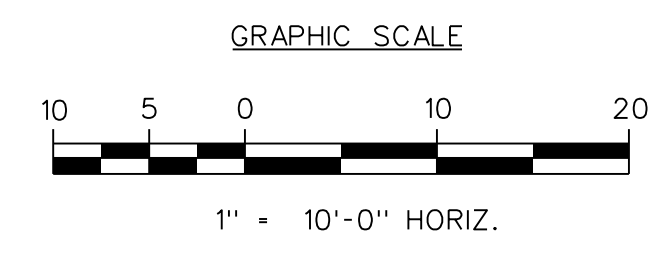
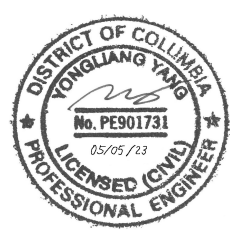

PSI
Precision Systems, Inc.
Engineers, Planners and Architects
WASHINGTON, D.C. (202) 686-8225 www.dcpsi.com

NO.	DESCRIPTION	NAME	DATE

DISTRICT OF COLUMBIA DEPARTMENT OF TRANSPORTATION TRAFFIC ENGINEERING AND SAFETY DIVISION		FINAL FIELD CHECKED BY RB / AYY
RHODE ISLAND AVENUE, 11TH STREET, AND Q STREET, N.W. BUS PLATFORM DETAIL PLAN		DESIGNED BY AYY
SUBMITTED BY _____ DATE _____		DRAWN BY UA / SZ
PROJECT ENGINEER _____ DATE _____		REVIEWED BY AYY
RECOMMENDED PROJECT MANAGER _____ DATE _____		DATE 05 / 23
APPROVED ASSOCIATE DIRECTOR, TESD _____ DATE _____		SCALE 1" = 10'
		SHEET 4 / 4
		DRAWING NO. SN-04

P:\80580-citywide engineering\working-temp\work order 38 & 39 - near nw 11th street q street and rhode island avenue nw\SN-P001-80580-38-bus-platform_details.dgn 5/8/2023